





Offered with no forward chain, this spacious detached home occupies a highly desirable position within a sought-after residential location. Providing generous and versatile accommodation throughout, the property presents an exciting opportunity for buyers looking to modernise, extend or create a long-term family home, subject to the necessary planning consents. Positioned close to the famous Goodwood.

The ground floor comprises a welcoming sitting room, dining room, well-proportioned kitchen and a bright conservatory overlooking the rear garden. Further accommodation includes a ground floor shower room and a useful utility/workshop area, offering excellent flexibility for a variety of lifestyles.

Upstairs, there are three bedrooms served by a family bathroom, with well-balanced accommodation throughout and scope to adapt to individual requirements.

Outside, the property benefits from a substantial garage, ample driveway parking and a private south-facing rear garden, ideal for enjoying sunshine throughout the day. The generous plot and established setting further enhance the property's future potential.

Located within easy reach of Chichester city centre, local amenities and transport links, this is a rare opportunity to acquire a home with significant scope in a highly regarded area.

EPC: D

Council Tax Band: F – £3,375.76 (2025/26)

- NO FORWARD CHAIN
- SOUGHT-AFTER LOCATION
- THREE BEDROOMS
- DETACHED FAMILY HOME
- SOUTH-FACING GARDEN
- GROUND FLOOR SHOWER ROOM
- DOUBLE GARAGE
- AMPLE DRIVEWAY PARKING
- CLOSE TO CHICHESTER CITY CENTRE
- USEFUL UTILITY AREA



# Harberton Crescent, Chichester

Approximate Gross Internal Area = 150.8 sq m / 1623 sq ft

(Excluding Reduced Headroom / Eaves)

Reduced Headroom = 0.3 sq m / 3 sq ft

Total = 151.1 sq m / 1626 sq ft

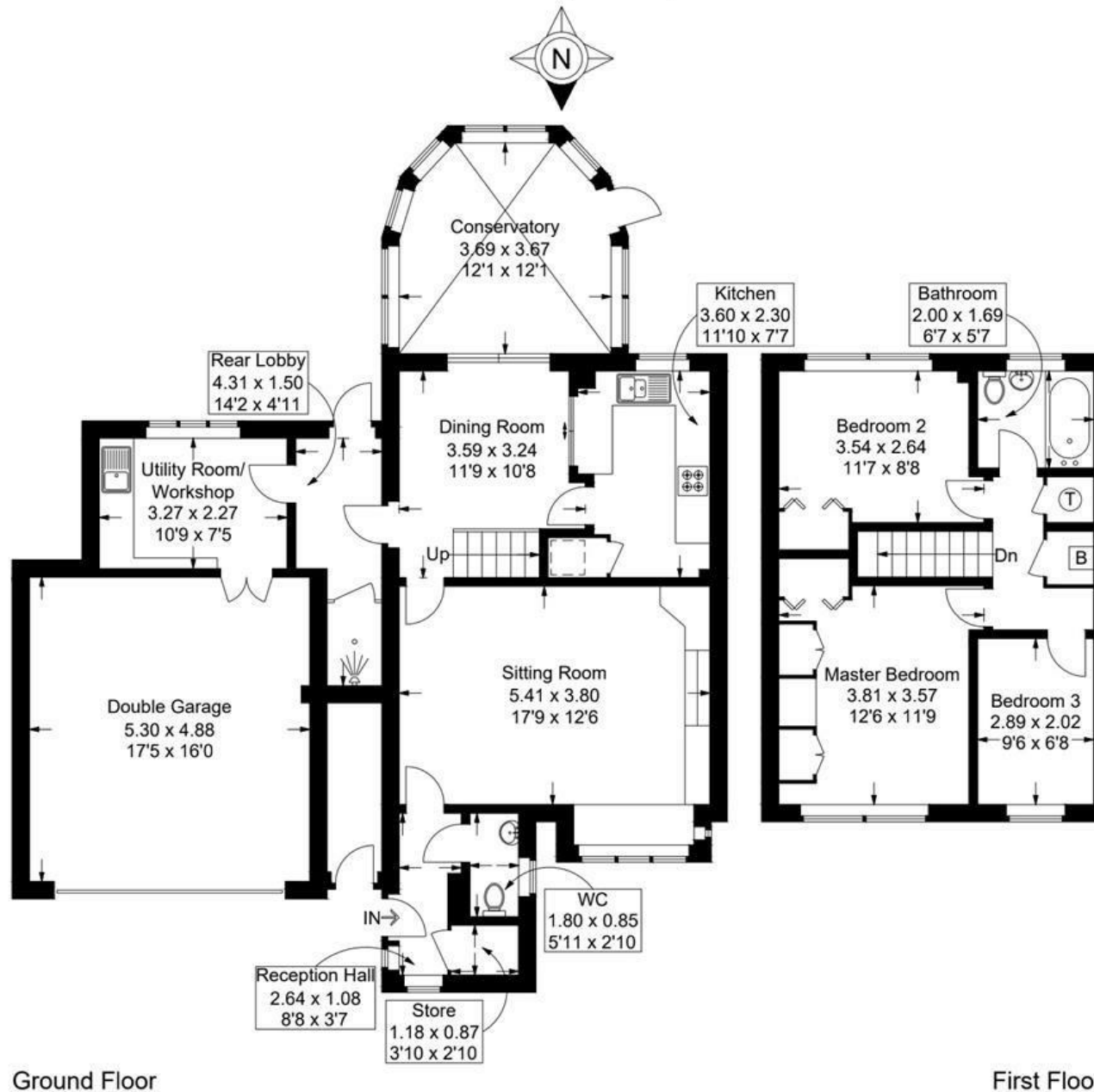

Ground Floor

First Floor

= Reduced headroom below 1.5m / 5'0

This plan is for layout guidance only. Not drawn to scale unless stated. Windows and door openings are approximate. Whilst every care is taken in the preparation of this plan, please check all dimensions, shapes and compass bearings before making any decisions reliant upon them.