

NEXA Properties delighted to be offering this beautifully presented first floor converted flat ideal for a single or professional couple. The property is situated in the lovely coastal village of Emsworth and has accommodation comprising hall, fitted kitchen, living room, double bedroom, bathroom, gas central heating and UPVC double glazing.

The home is conveniently positioned for access to the A259, A27 and A3 and lies close to the foreshore of Chichester Harbour and direct train line into London Stations. Situated in the harbour-side village of Emsworth which offers a thriving community with a village square, independent shops, medical facilities, pubs, restaurants, sailing clubs and scenic coastal walks.

Agents note - The property is share of the freehold and is currently in the process of having a lease extension (which will be complete prior to purchase completion).

- Fitted kitchen
- Double bedroom
- Converted first floor apartment
- Bathroom
- Double Glazing
- Gas Central Heating
- Central Emsworth Location
- Ideal holiday let or rental investment



North Street, Emsworth

Approximate Gross Internal Area = 43.1 sq m / 464 sq ft

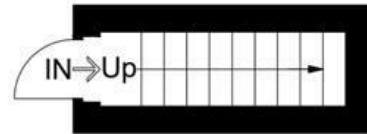

Ground Floor

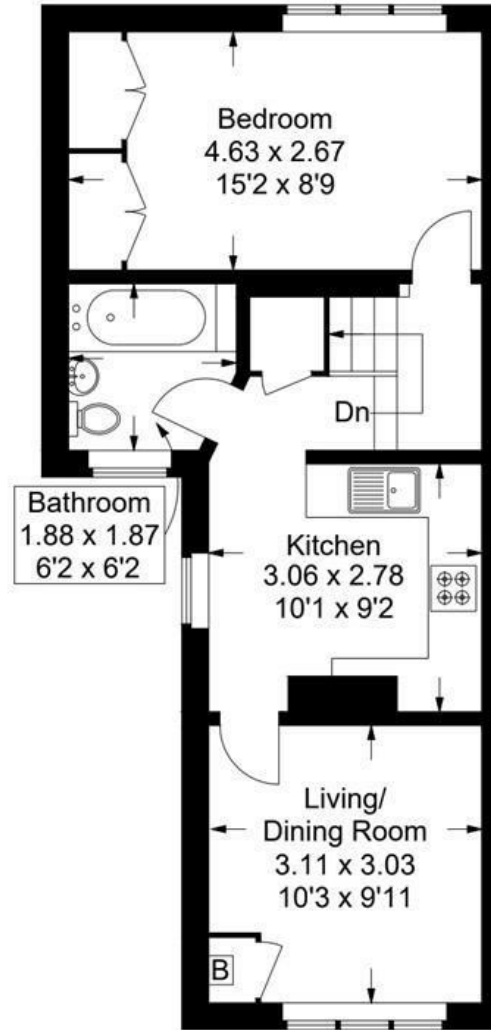

First Floor

This plan is for layout guidance only. Not drawn to scale unless stated. Windows and door openings are approximate. Whilst every care is taken in the preparation of this plan, please check all dimensions, shapes and compass bearings before making any decisions reliant upon them.