





This spacious two-bedroom second-floor flat offers modern living in a convenient and well-connected location, making it an excellent choice for first-time buyers or investors alike. The property benefits from a bright, airy layout and a balcony that enhances both the appeal and functionality of the space. Positioned close to local amenities and major transport links, this home provides easy access to everything you need for day-to-day life.

- SPACIOUS LOUNGE/DINER
- MODERN FITTED KITCHEN
 - TWO WELL PROPORTIONED BEDROOMS
- STYLISH BATHROOM
- PRIVATE BALCONY
- BRIGHT AND AIRY THROUGHOUT
- GREAT TRANSPORT LINKS
- CLOSE TO LOCAL SHOPS AND CAFES
- IDEAL FOR FIRST-TIME BUYERS OR INVESTORS
- SITUATED ON THE SECOND FLOOR



Gosport House, Prospect Lane, Havant

Approximate Gross Internal Area = 67.9 sq m / 731 sq ft

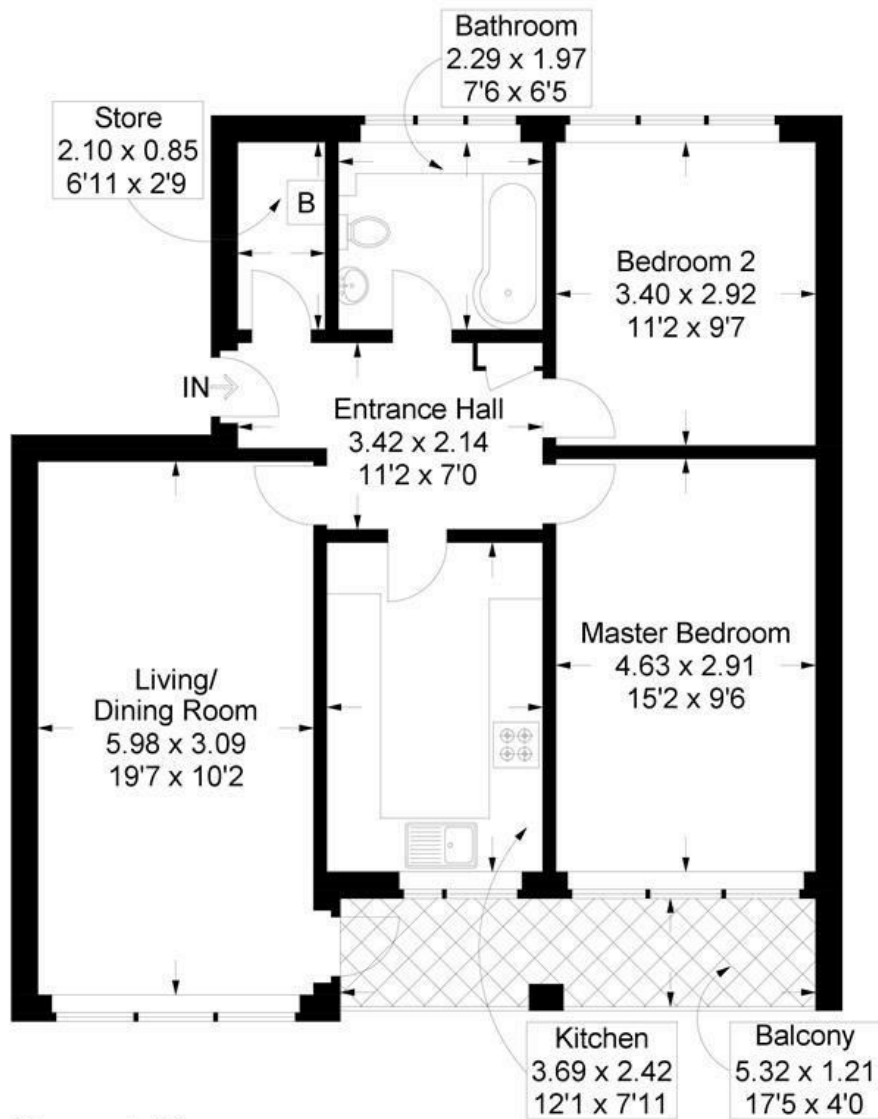

Second Floor

This plan is for layout guidance only. Not drawn to scale unless stated. Windows and door openings are approximate. Whilst every care is taken in the preparation of this plan, please check all dimensions, shapes and compass bearings before making any decisions reliant upon them.