





Set in a peaceful cul-de-sac with Hampshire Farm Meadows on your doorstep, this immaculately presented three-bedroom home is just a short distance from Emsworth town centre and the village of Westbourne. With a stunning orangery-style extension, a south-facing garden and the convenience of a garage and parking, this home offers modern living in a prime location.

- South Facing Rear Garden
- Three Bedroom Family Home
- GARAGE and Parking
- Huge Downstairs Layout
- En-suite, Bathroom and WC
- Hampshire Farm Meadow on the Doorstep



# Spire View, Emsworth

Approximate Gross Internal Area = 100.4 sq m / 1081 sq ft

Outbuilding = 18.2 sq m / 196 sq ft

Total = 118.6 sq m / 1277 sq ft

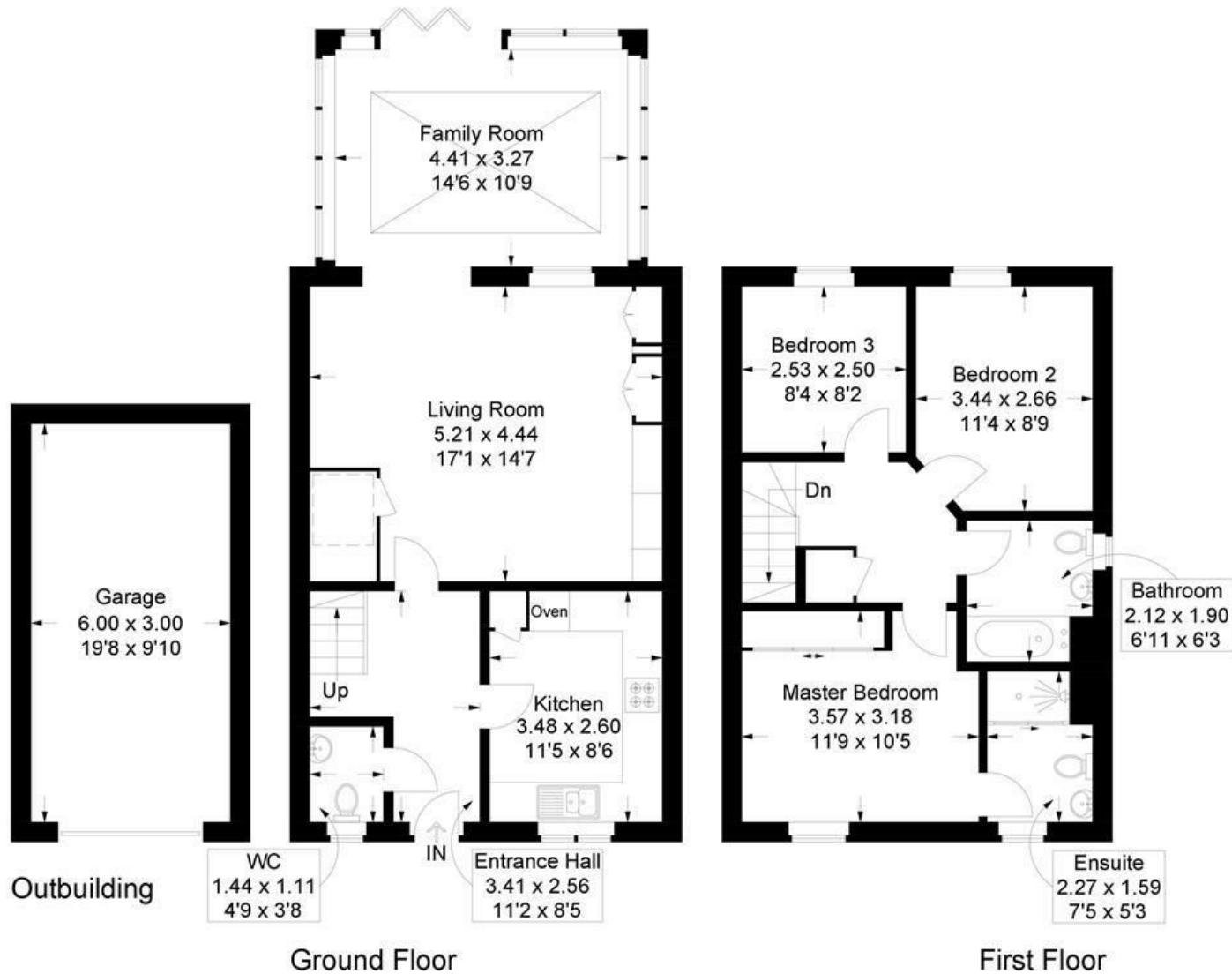

 = Reduced headroom below 1.5m / 5'0

This plan is for layout guidance only. Not drawn to scale unless stated. Windows and door openings are approximate. Whilst every care is taken in the preparation of this plan, please check all dimensions, shapes and compass bearings before making any decisions reliant upon them.