





A spacious two-bedroom first-floor apartment which has recently been extensively refurbished by the current owners, featuring a generous layout, a private balcony with views of the River Hamble and the added benefit of a garage, a private store room and dedicated parking. Situated within the exclusive River Green development.

- Spacious two-bedroom first-floor apartment
- Recently refurbished to high standards
- Exclusive River Green development location
- Communal gardens with quay access
- Includes garage and private store
- EPC rating: D (68)



# River Green, Hamble

Approximate Gross Internal Area = 83.4 sq m / 898 sq ft

Outbuildings = 15.4 sq m / 166 sq ft

Total = 98.8 sq m / 1064 sq ft

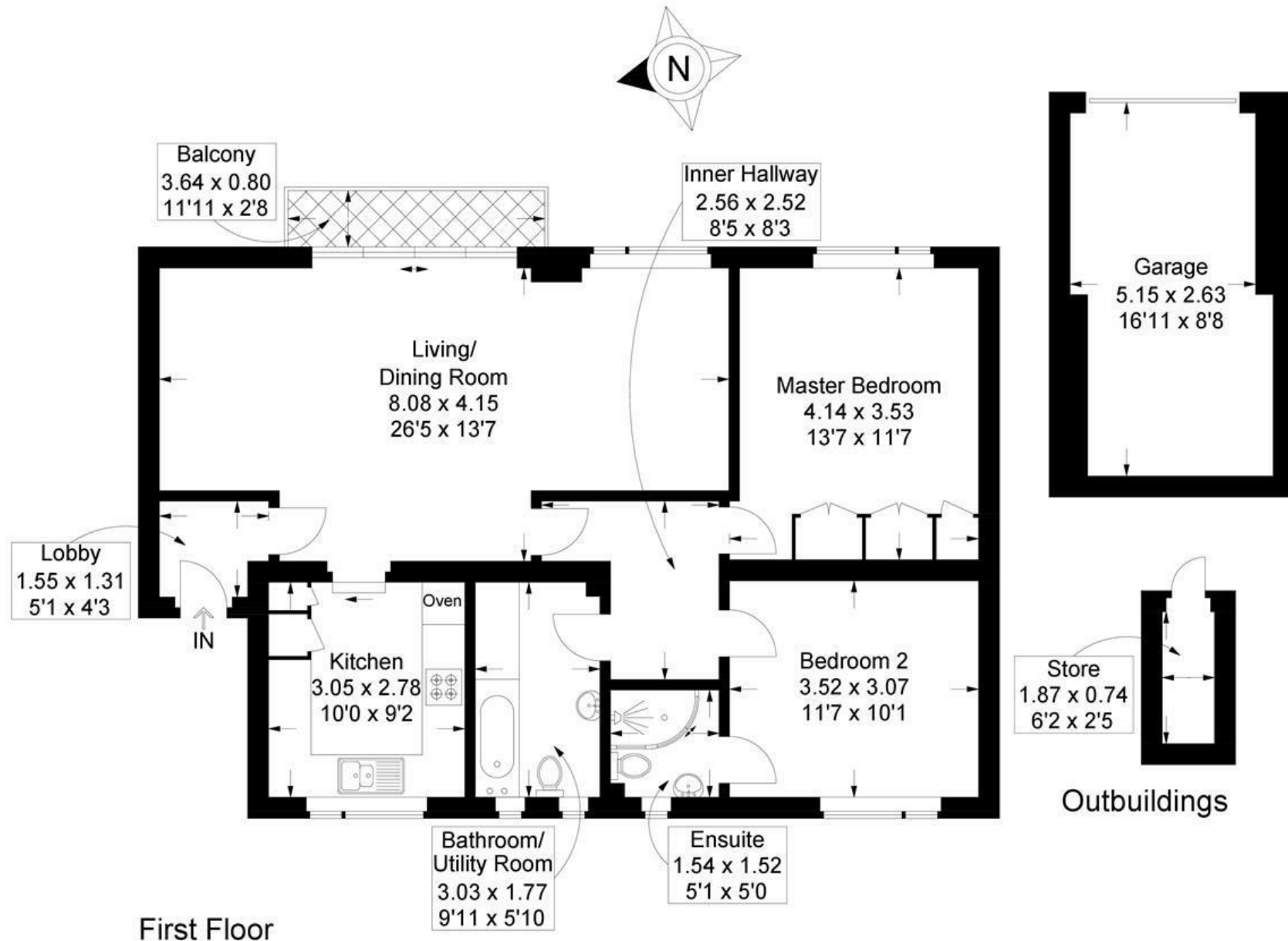

This plan is for layout guidance only. Not drawn to scale unless stated. Windows and door openings are approximate. Whilst every care is taken in the preparation of this plan, please check all dimensions, shapes and compass bearings before making any decisions reliant upon them.