





AT A GLANCE

-  Superb Cul De Sac Location
-  Garage & Off Road Parking
-  Recently Refurbished & Redecorated
-  Modern Fitted Kitchen
-  Breakfast Bar
-  Two Double Bedrooms
-  En-Suite To Master
-  Elegant Family Bathroom
-  Private Garden
-  200m to The Harvest Home





ABOUT THE PROPERTY

Welcome to this impeccably presented home, boasting recently upgraded bathrooms and a modern kitchen complete with a charming breakfast area, ideal for starting your day in style.

The inviting living room, enhanced with ample space for a dining room table and chairs, opens up to a private garden through double glazed sliding doors, flooding the space with an abundance of natural light.

As you explore further, you'll find two double bedrooms, each with built-in double wardrobes for added convenience. The master bedroom takes luxury to the next level with its own stylish en-suite shower room, featuring sleek chrome towel rail radiators for a touch of elegance.

Indulge in relaxation within the family bathroom, a masterpiece of the recent refurbishment project, showcasing an elegant roll-edge bath with feet, a traditional-style pedestal sink, and a low-level WC.

Adding to the allure of this stunning residence are the practicalities of a downstairs WC and a garage with off-road parking, accessible from both the front drive and the rear garden for ultimate convenience.





ABOUT THE PROPERTY

Nestled in a tranquil cul-de-sac, this home provides easy access to local amenities. Enjoy leisurely strolls to The Harvester Inn a mere 200m away for a refreshing drink or head to the nearby play park for some family fun. Just a short 15 minute walk away, discover the vibrant village center bustling with an array of amenities, including quaint convenience stores, two further pubs, charming restaurants, and the historic village church.

Denmead's picturesque countryside setting makes it a paradise for outdoor enthusiasts. Explore the intricate network of natural paths meandering through lush woods adorned with majestic trees and vibrant heather, perfect for both leisurely walkers and avid cyclists alike. With its horseback riding trails, dog-friendly footpaths, and ample parking facilities, this enchanting wooded wonderland is sure to capture the hearts of all who visit. Welcome to your own piece of paradise in Denmead.







Hatchmore Road, Denmead

Approximate Gross Internal Area = 61 sq m / 657 sq ft
 Outbuilding = 18.7 sq m / 201 sq ft
 Total = 79.7 sq m / 858 sq ft

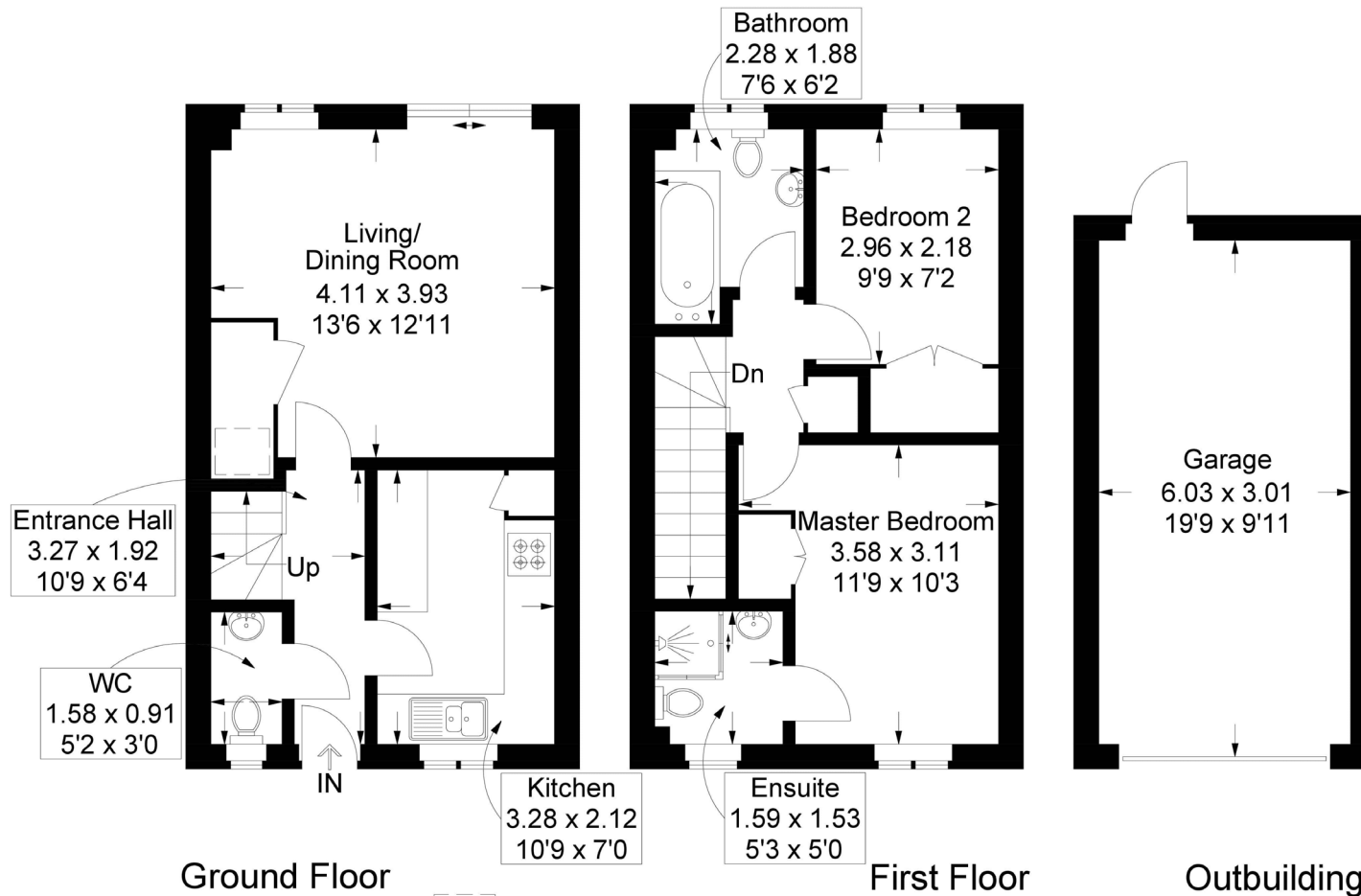

= Reduced headroom below 1.5m / 5'0

This plan is for layout guidance only. Not drawn to scale unless stated. Windows and door openings are approximate. Whilst every care is taken in the preparation of this plan, please check all dimensions, shapes and compass bearings before making any decisions reliant upon them.



LOCATION

Denmead, nestled in the picturesque countryside of Hampshire, exudes a quaint charm and peaceful ambiance that captivates visitors and residents alike. Surrounded by rolling hills, verdant meadows, and ancient woodlands, Denmead offers a tranquil escape from the hustle and bustle of modern life.

The village itself boasts a rich history dating back centuries, evident in its charming architecture and well-preserved landmarks. Stroll through its winding streets adorned with quaint cottages, visit the historic village church, or explore the local heritage at the Denmead Museum.

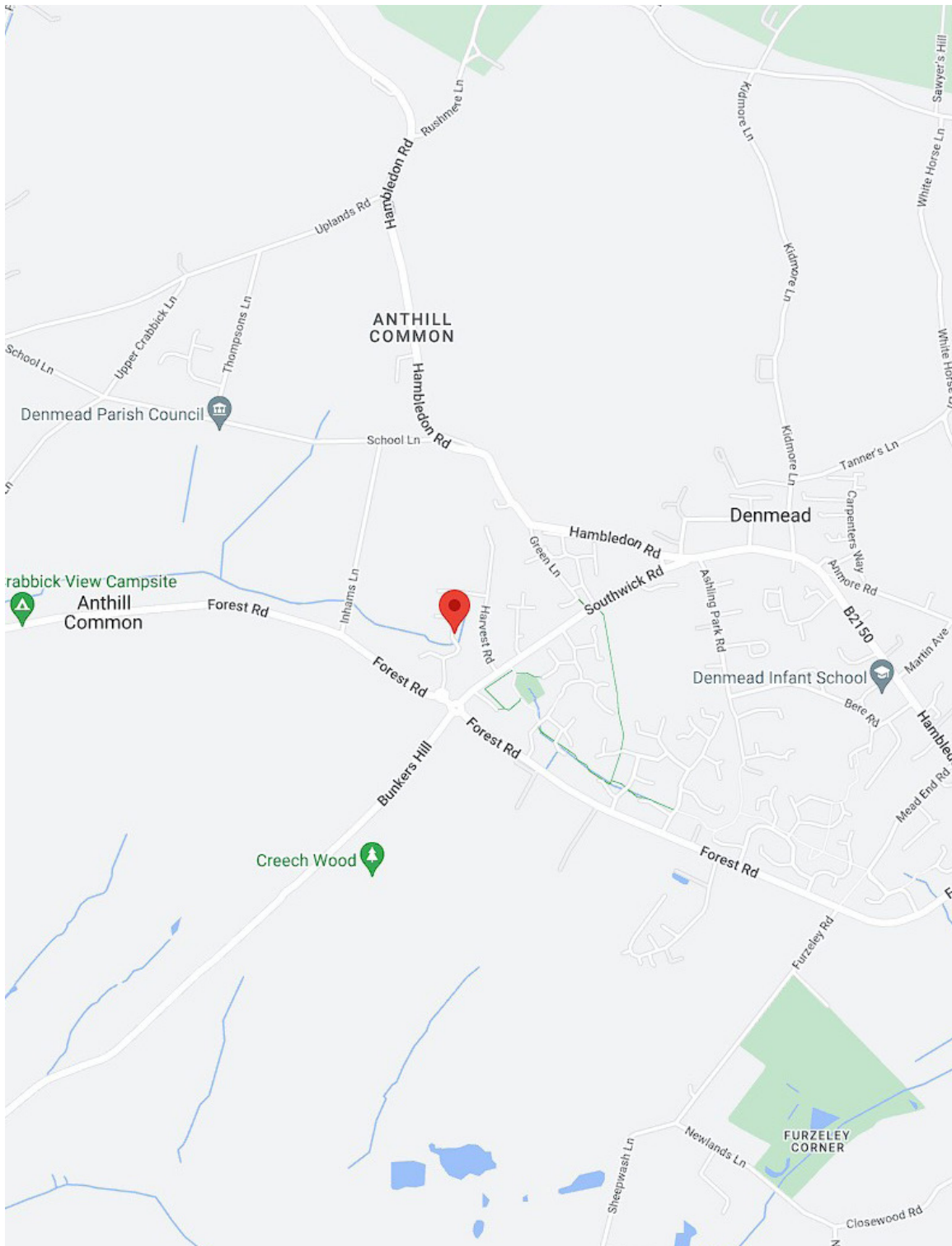



THE AGENT

Christopher Smeed
Client Director - Sales & Lettings

Chris is an award winning director of estate agency and brings over 25 years of experience to the NEXA team. Winning Gold Best Customer Service 2021, he has continuously delivered excellent standards of customer service throughout his career and specialises in overcoming even the most challenging of property related cases.

The NEXA team is strengthened by having his passion and desire to succeed whilst retaining integrity and honesty throughout the sale process which is why his customers both old and new return time and time again.

Chris and his family are members at Emsworth & Hayling Island Sailing Clubs where he and his family sail.

Christopher Smeed, dedicated agent, loving husband and proud father of 4!

✉ Chris@nexaproperties.com

📞 07770 758589

📷 @christophersmeed

[in](#) Christopher Smeed



WHY CHOOSE NEXA?

We are a different type of estate agency. We provide you with a local industry professional to act as your dedicated Client Director who will be your single point of contact. This means you only ever deal with one agent and you receive a seamless and transparent solution.

Our unique business model rewards our Client Directors on a highly competitive results-based structure. This enables us to source the best people for the job and to create a better experience for you, and a more rewarding and motivating experience for our staff.

Your Client Director is personally assigned to you and will provide a personal service from start to finish through the entire journey, available any time of day. This enables us to create a high-performance culture and a customer-centric estate agency.





NEED A MORTGAGE?

We work closely with a small, handpicked selection of professional mortgage brokers who can help you find the right mortgage. There are some great deals out there and a good mortgage broker can help you find them whilst also revealing the loopholes and limitations that apply. This will help to ensure that you find the best lender and agreement for your circumstances and plans. Talk to your NEXA Agent and they will arrange your meeting with one of our excellent mortgage brokers.

NEED A SOLICITOR?

Having worked in property for many years, we have been fortunate enough to build relationships with a number of excellent legal firms and solicitors that specialise in property transactions and contracts. We now work closely with these firms to ensure that our clients have access to the best legal support available in the City. Simply talk to your NEXA agent who will help you find the best solicitor for your needs.





023 9229 5046 | hello@nexaproperties.com | www.nexaproperties.com

15 Hampshire Terrace, Southsea, Portsmouth PO1 2QF

