



Melrose, Cardiff Road, Hawthorn, Pontypridd, CF37 5AG

£335,000



- RENOVATION REQUIRED
- DETACHED
- GARAGE
- DRIVEWAY
- DESIRABLE LOCATION
- NO CHAIN
- 3 BEDROOMS
- LARGE GARDEN
- CLOSE TO LOCAL AMENITIES & SCHOOLS
- EPC E

## THE PROPERTY

Are you looking for a large family home to renovate with lots of potential? Take a look at this three-bedroom detached family home situated in a popular area of Hawthorn.

The property benefits from being within walking distance to local amenities and bus links and Pontypridd Town Centre with the train station being only a short drive away. Further benefits include good road links to the city centre as the M4 and the A470 making this an ideal spot for commuters.

The Ground floors comprises of Entrance hallway, Lounge, Office space and Kitchen. To the first floor there are three good size bedrooms and family bathroom

To the front of the property set back from the road there is a well-maintained garden with a shared access driveway with parking for several cars and a garage. To the rear of the house there is a large garden to the rear which has been partially fenced off with a large area of the garden requiring attention Viewing is highly recommended.

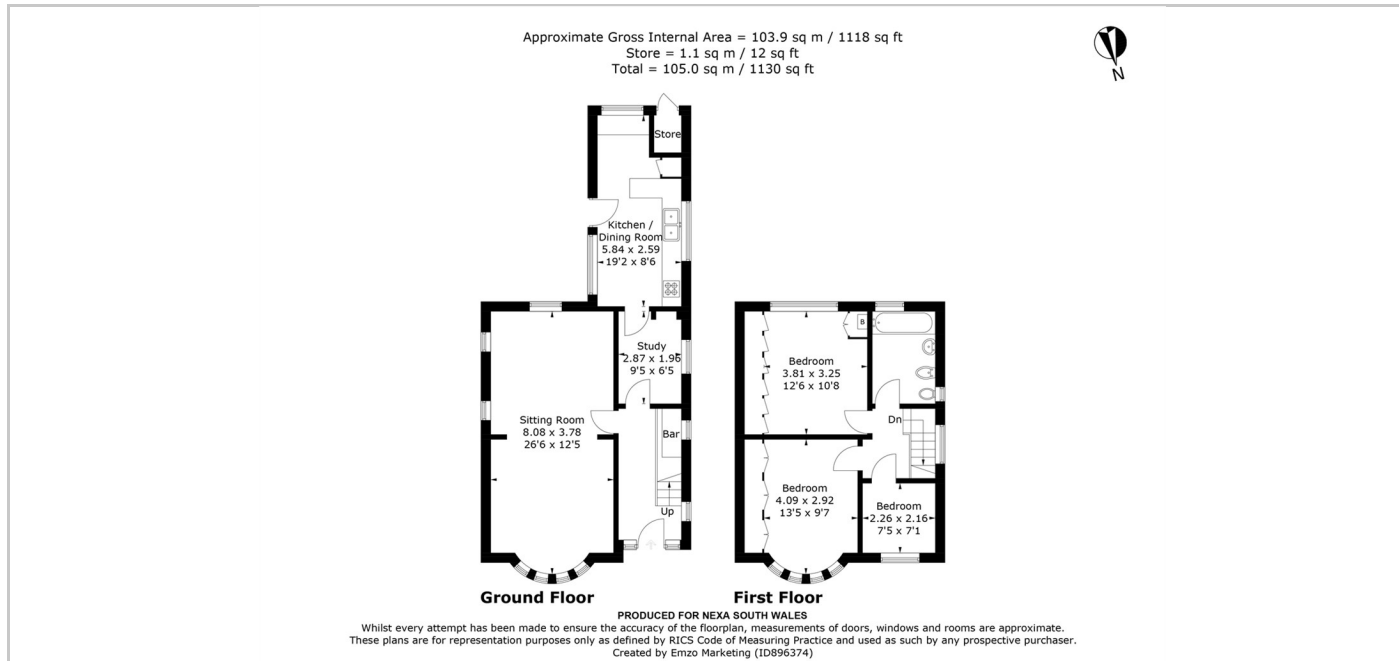

## Directions