

NEXA
SOUTH WALES



Castle Buildings, 3 Forest Road, Treforest, Pontypridd, CF37 1SZ

£145,000

- INVESTERS ONLY
- HMO LICENCED
- 4 BEDROOMS
- CLOSE TO UNIVERSITY
- TENANTED 22/23
- EPC C
- TAX BAND C

THE PROPERTY

** HMO LICENCED* * TENANTED 22/23* * CLOSE TO UNIVERSITY* * INVESTORS ONLY*

Nexa Estate Agents are pleased to present to the market this spacious four bedroom property in the Treforest area of Pontypridd. The property has a full HMO and is within walking distance to the University of South Wales.

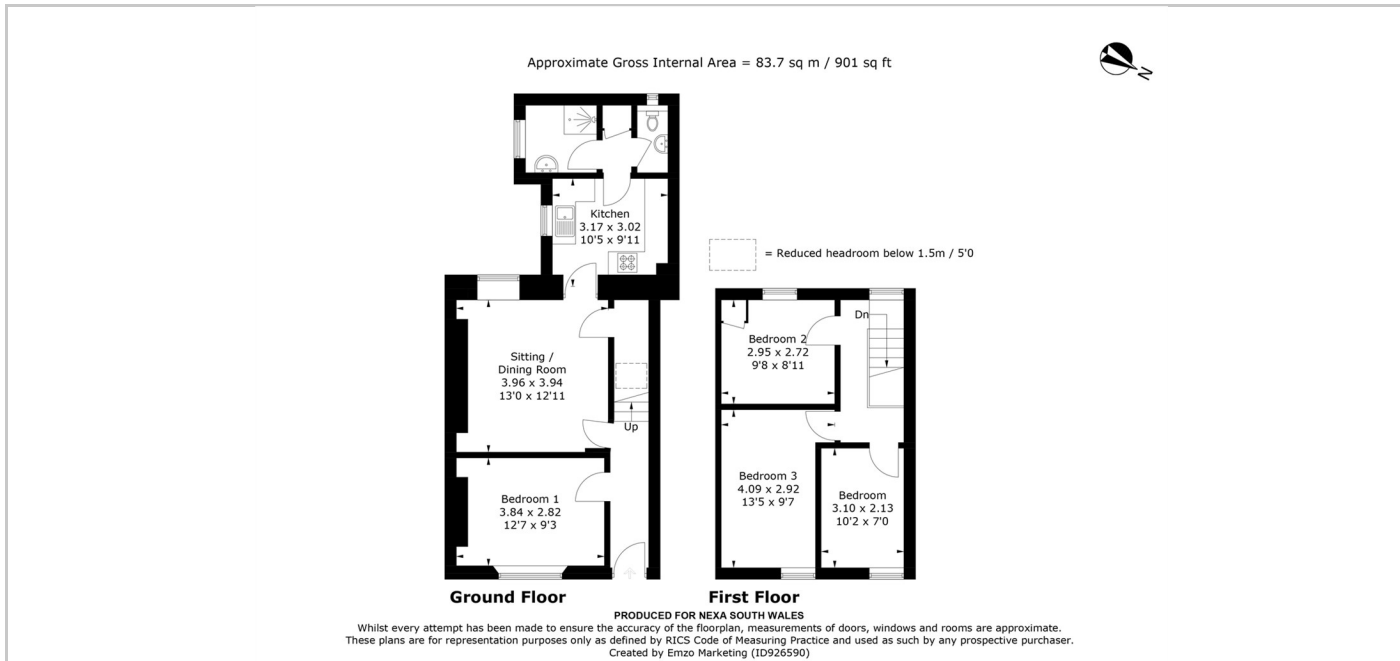

SITUATION

Directions