

4 New Park Terrace, Treforest, Pontypridd, CF37 1TH

£125,000

- HMO LICENCED 4 PEOPLE
- 4 BEDROOMS
- 2 BATHROOMS
- CLOSE TO UNIVERSITY
- GARAGE

THE PROPERTY

****TENANTED 22/23**** ****HMO LICENCED****
****INVESTORS ONLY****

Nexa are pleased to offer for sale this 4 bedroom, 2 bathroom HMO Property which is located within a prime location, close to the University of South Wales, transport links and all local amenities..

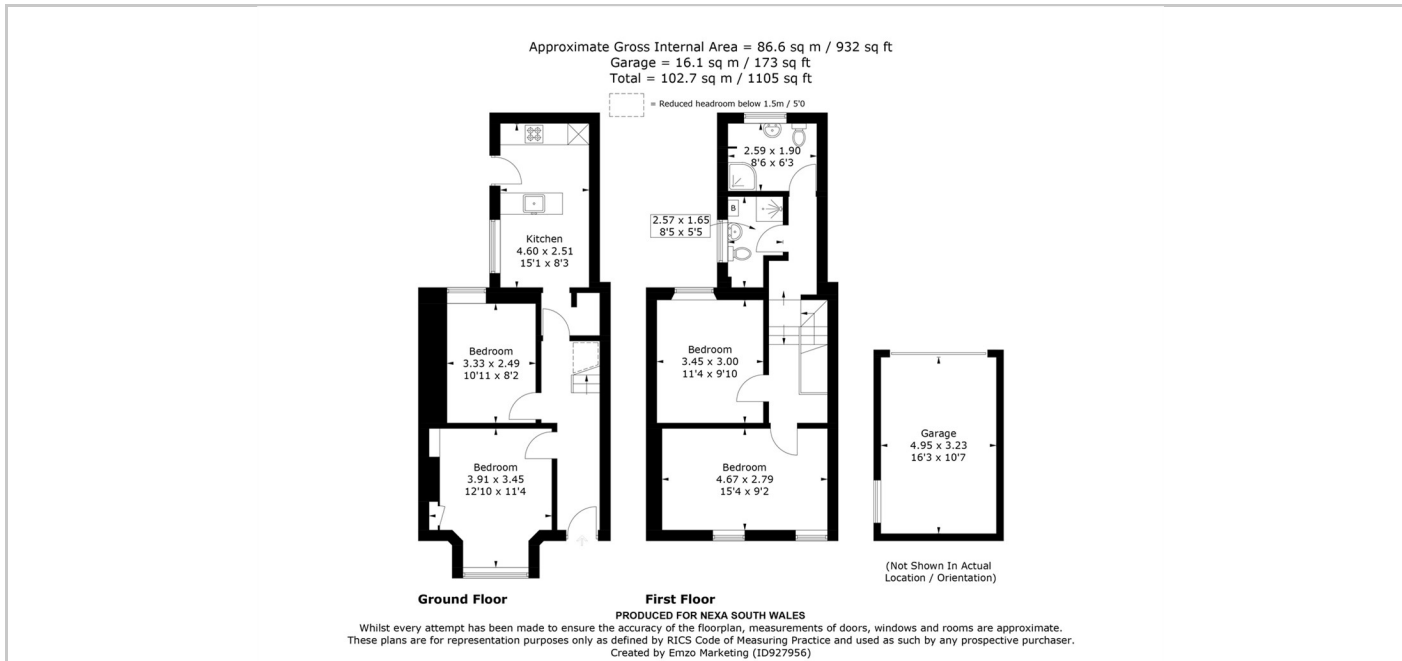

SITUATION

Directions