

Approximate Gross Internal Area = 55.0 sq m / 592 sq ft
Store = 10.4 sq m / 112 sq ft
Total = 65.4 sq m / 704 sq ft

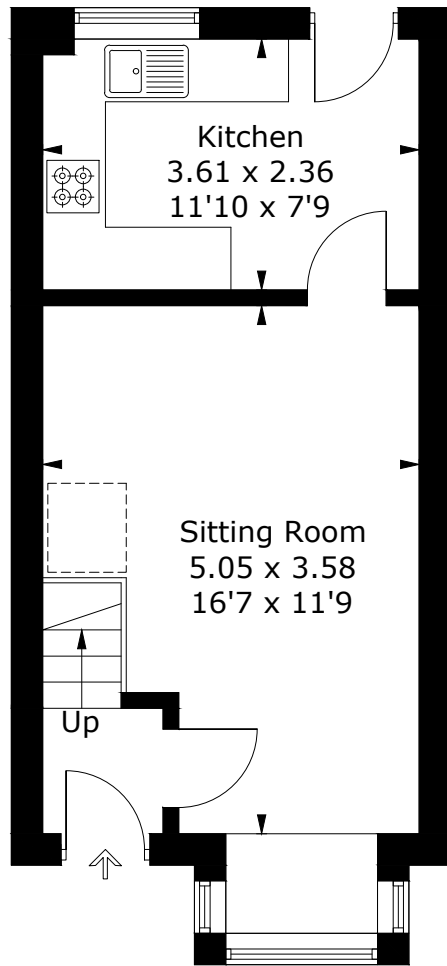

 = Reduced headroom below 1.5m / 5'0



Ground Floor

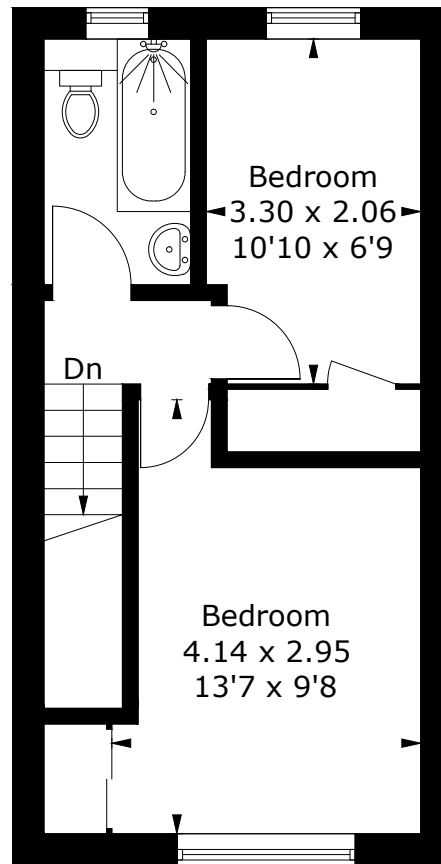

First Floor

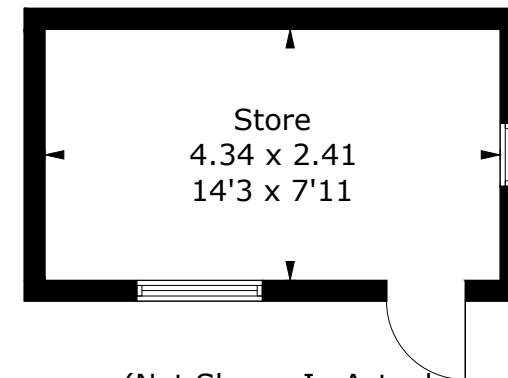

(Not Shown In Actual
Location / Orientation)

PRODUCED FOR NEXA SOUTH WALES

Whilst every attempt has been made to ensure the accuracy of the floorplan, measurements of doors, windows and rooms are approximate. These plans are for representation purposes only as defined by RICS Code of Measuring Practice and used as such by any prospective purchaser.

Created by Emzo Marketing (ID986384)