

**NEXA**  
BRISTOL



**TO LET**



6 Bevan Road, Bitton, Bristol, BS30 6AE

**£465,000**

- Four Bedrooms
- Heart of Bitton Mill
- The Meadows Primary School within walking distance
- Integral Garage
- 2019 Linden Home
- EPCB
- Spacious Town House
- Close to Wilsbridge cycle track
- Off Road Parking
- Viewings available 7 days a week

## THE PROPERTY

Carly Hales of NEXA PROPERTIES is thrilled to present this beautiful four-bedroom home to the market.

Bitton Mill is a charming development offering an enviable location between Bristol and Bath in a semi-rural setting. Built to retain the character of the old mill buildings, this house has exceptional proportions throughout.

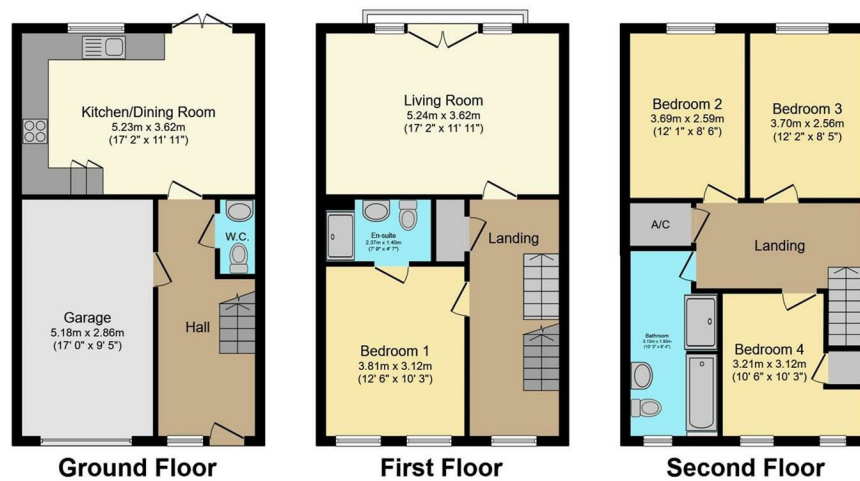

Total floor area 142.0 sq.m. (1,528 sq.ft.) approx  
This plan is for illustration purposes only and may not be representative of the property. Plan not to scale. Powered by PropertyBox

## SITUATION

## Directions