

NEXA
BRISTOL



TO LET



Flat 2, 4 Jesmond Road, Clevedon, BS21 7PA

£210,000

- Ground Floor Apartment
- Allocated Parking
- Modern Fitted Shower Room
- Useful Cellar for Storage
- Within 10 Minute Walk of Town Centre
- One Double Bedroom
- Modern Fitted Kitchen
- Period Features & Feature Fireplaces
- Ideal First Time or Investment Buy
- EPC - D

THE PROPERTY

Simon @ NEXA Bristol is delighted to offer for sale this ideal first time or investment buy. A spacious one bedroom ground floor apartment with allocated parking and useful storage cellar in Mid Clevedon being mid-way between Clevedon Town Centre and Clevedon Seafront.

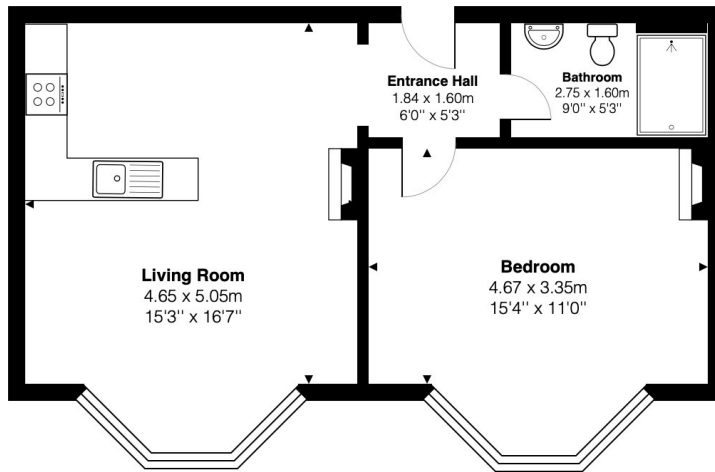

SITUATION

Directions