



29 Weare Court, Canada Way, Bristol, BS1 6XF

**£205,000**

- ONE BEDROOM APARTMENT
- ALLOCATED PARKING
- CENTRAL LOCATION
- OPEN PLAN LIVING
- EXCELLENT CONDITION
- CLOSE TO RIVER
- IDEAL FOR FIRST TIME BUYERS OR INVESTORS
- OWN FRONT DOOR

## THE PROPERTY

This 1-bedroom flat offers a contemporary living experience with a modern finish, shower room, off-street parking, and a convenient location near the harbourside. The thoughtful design, combined with the property's urban charm, presents a unique opportunity to embrace Bristol's dynamic lifestyle while enjoying comfort and style.

Total Approximate Gross Internal Area = 26.9 sq m/ 289.6 sq ft

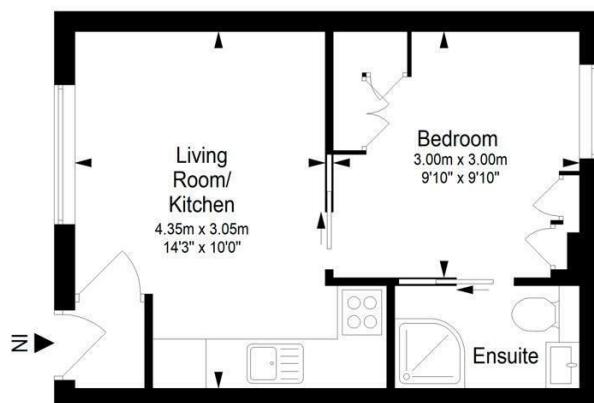

### Ground Floor

This floor plan has been drawn using RICS guidelines (GIA)

Disclaimer : Please note this floor plan is for marketing purposes and is to be used as guide only.  
All Efforts have been made to ensure its accuracy at time of print

## SITUATION

## Directions