

NEXA
BRISTOL



TO LET



53a Mile Walk, Bristol, BS14 0SL

£160,000

- PRIVATE GARDEN
- PRIVATE ENTRANCE
- MODERN AND WELL PRESENTED
- OPEN PLAN
- GAS CENTRAL HEATING
- ALLOCATED PARKING
- EN-SUITE SHOWER ROOM
- LOCKABLE STORAGE

THE PROPERTY

Nexa is pleased to bring to the market a pleasantly presented one bedroom garden flat situated in a popular area in South Bristol.

Ground Floor Flat, Mile Hill Walk, Bristol, BS14 0SL

Approximate Gross Internal Area = 34 sq m / 366 sq ft

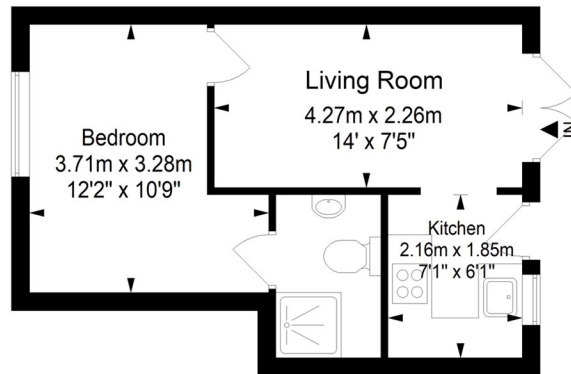

This floor plan has been drawn using RICS guidelines (GIA)

Disclaimer : Please note this floor plan is for marketing purposes and is to be used as guide only.
All Efforts have been made to ensure its accuracy at time of print

SITUATION

Directions

Unit 28, Cargo2 Museum Street, Bristol, BS1 6ZA

Tel: 01173634411 Email: hello@nexabristol.com <https://www.nexaproperties.com/>