



TO LET

4 Penny Lane, Hermitage, Emsworth, Hants, PO10 8HE

£775,000

- Over 2000 sq ft. Stunning Detached Family Home
- Outdoor Kitchen With Mains Gas Grill
- Under Floor Heating & Air Conditioning
- Remote Control Gated Entrance
- Large Hardwood Deck Area
- Four Bedrooms & Two Bathrooms
- 30' x 25' Open Plan Kitchen Family Room
- Utility Room / Play Room / Work Shop
- Off Road Parking For Several Cars
- Beautiful Gardens With Outdoor Shower

THE PROPERTY

With over 2000 sq ft with a 30' x 25' open plan family area this stunning home will make you the envy of your friends & family. With 4 bedrooms, 2 bathrooms, underfloor heating and air conditioning there is plenty to appreciate in this magnificent property. Watch the video and book your appointment!

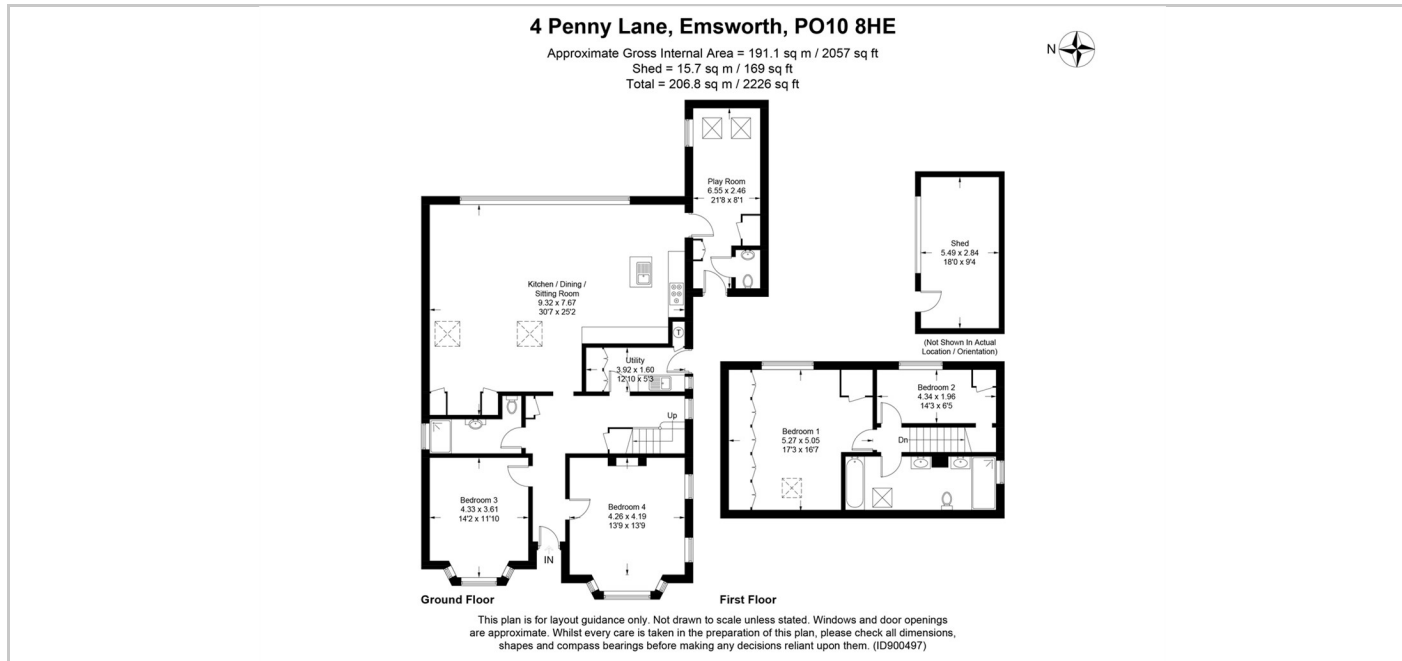

SITUATION

Directions