



**TO LET**

5 Harbour Road, Hayling Island, PO11 0HR

£730,000

- FIVE BEDROOM DETACHED PROPERTY
- OFF-ROAD PARKING FOR 5+ CARS ASWELL AS GARAGE
- 500 YARDS FROM THE BEACH
- OVER 3,000 SQ FT OF SOUTH-FACING GARDEN
- OPEN PLAN KITCHEN DINER FAMILY ROOM WITH KITCHEN ISLAND
- UTILITY ROOM AND CLOAKROOM
- EN-SUITE BATHROOM
- SEPARATE 'SNUG' LIVING ROOM
- NO ONWARD CHAIN - VACANT AS OF MID-FEBRUARY
- TRI-FOLDINGS DOORS ON TO THE PATIO

## THE PROPERTY

STUNNING HOME WITH OPEN PLAN KITCHEN DINER FAMILY ROOM, WITH TRI-FOLDING DOORS ON TO THE GARDEN \*\* JUST 500 YARDS FROM THE BEACH \*\* 2,000 + SQ.FT OF LIVING ACCOMMODATION INTERNALLY \*\* VACANT AS OF MID-APRIL SO OFFERED WITH NO FORWARD CHAIN.

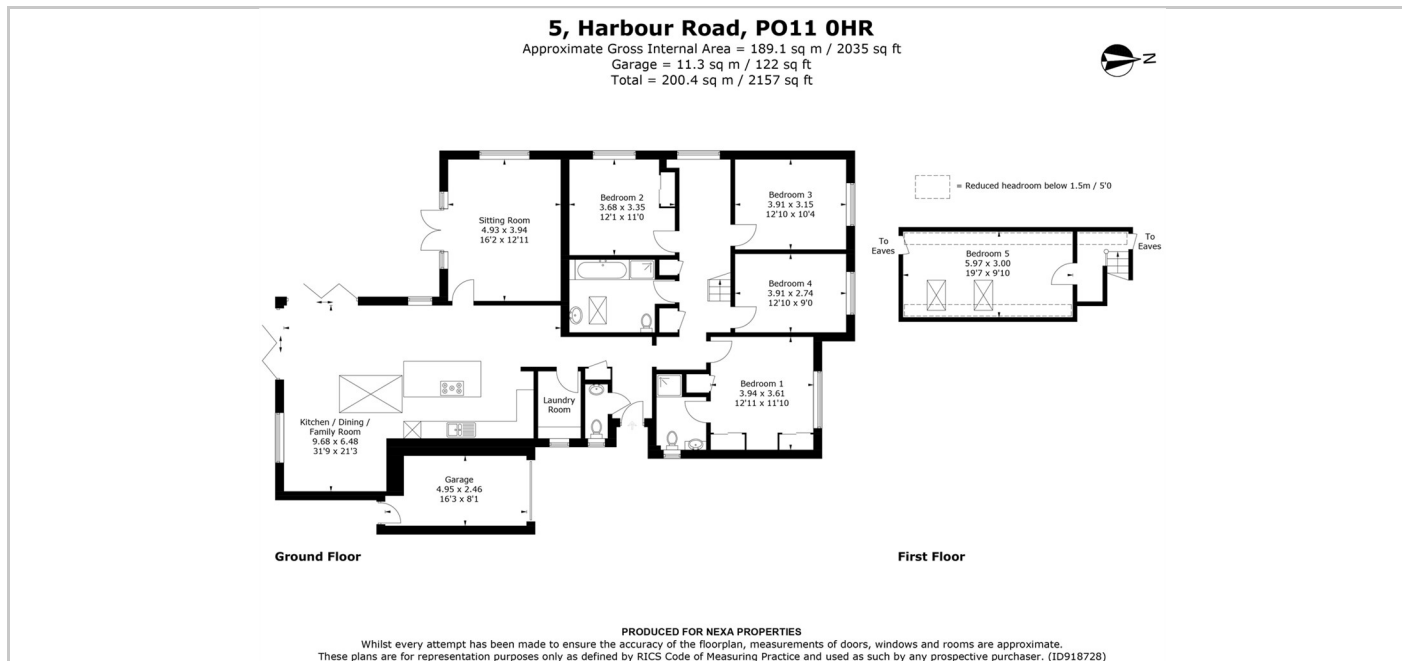

## SITUATION

## Directions

15 Hampshire Terrace, Southsea, Portsmouth, Hants, PO1 2QF  
 Tel: 02392295046 Email: [hello@nexaproPERTIES.com](mailto:hello@nexaproPERTIES.com) <https://www.nexaproPERTIES.com/>