



**TO LET**

15 Paddock End, Denmead, Waterlooville, Hants, PO7 6UW

**£425,000**

- Detached House
- 3/4 Bedrooms
- Private Rear Garden
- Modern Kitchen
- Downstairs Cloakroom/WC
- Versatile Accommodation
- Beautiful Conservatory
- Peaceful Rural Setting
- Two Bathrooms
- Garage & Plenty Of Parking

## THE PROPERTY

A spacious detached home in the heart of the popular village of Denmead. Suiting most purchasers this delightful property is quite versatile with extra rooms on the ground floor including the superb conservatory which now benefits from a hard roof. This gives better insulation and makes it more pleasant in the summer. The gardens are a good size and offer plenty of parking to the front and privacy to the rear.

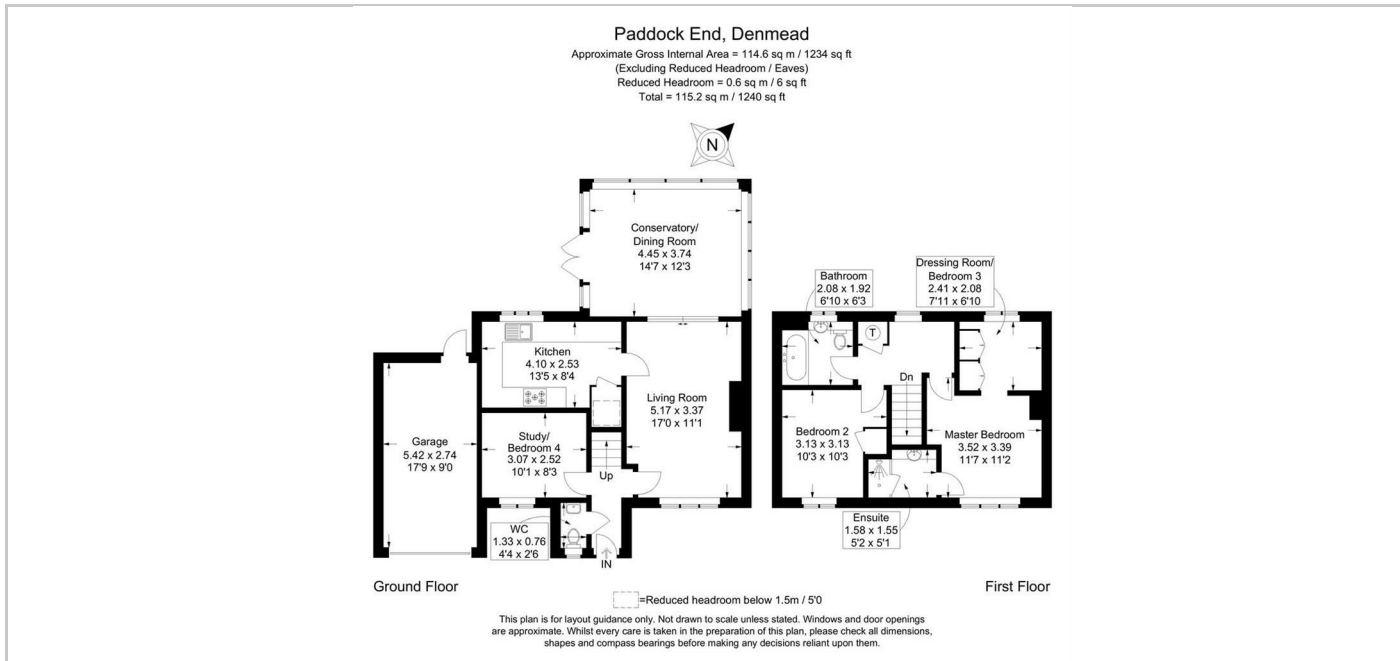

## SITUATION

## Directions