

**NEXA**  
PROPERTIES



**TO LET**



15 Osborne Road, Petersfield, Hants, GU32 2AE

£425,000

- Edwardian Family Home
- Three Double Bedrooms
- Log Burner & Second Fireplace Gas Fire
- Ground Floor Additional Utility Area
- Town Centre Location
- Some Original Period Features
- Good Size Living / Dining Room
- First Floor Bathroom
- Cloakroom with WC
- No Through Road

## THE PROPERTY

A period home with 3 double bedrooms in a sought after, town centre road. Petersfield has excellent transport & London Waterloo line is a few minutes walk away. Spacious living area with log burner plus gas fire and double doors leading out on to 55' garden. Guide Price £425,000 - £450,000

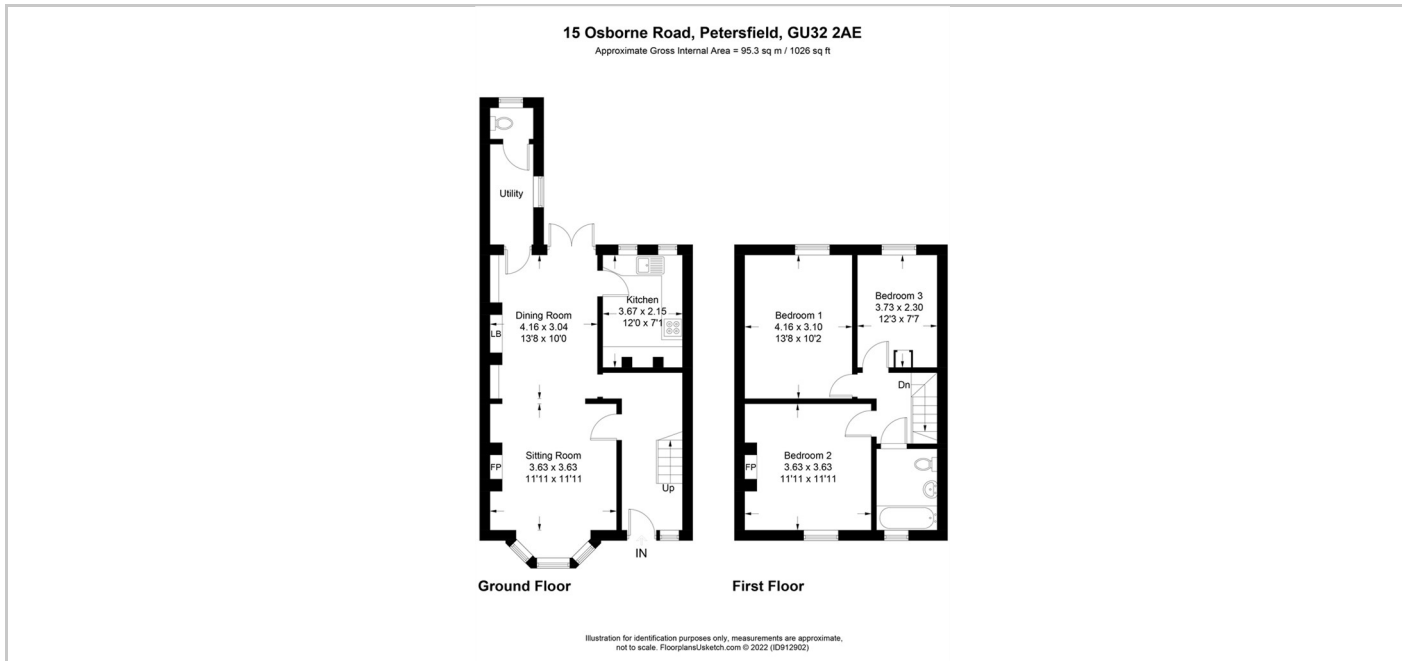

## SITUATION

## Directions