

NEXA
PROPERTIES



TO LET



34 Bertie Road, Southsea, PO4 8JX

£235,000

- GUIDE PRICE £235,000 - £240,000
- NO ONWARD CHAIN
- IDEAL FOR FIRST TIME BUYERS
- TWO RECEPTION ROOMS
- DOUBLE BEDROOMS
- MODERN KITCHEN
- NEW DECORATION
- VIDEO AVAILABLE
- A MUST SEE PROPERTY
- SORT AFTER LOCATION

THE PROPERTY

GUIDE PRICE £235,000 - £240,000

NO ONWARD CHAIN

NEXA Properties are delighted to welcome to market, this very well presented two bedroom terraced house situated in the sought after location of Bertie Road, Southsea.

Comprised of two spacious reception rooms, the first is newly decorated and with new carpet and the second with an open plan feel and laminate flooring, this leading on to a modern kitchen and a bathroom suite with shower over bath, WC and basin.

Upstairs offer two good size double double bedrooms, the first with laminate flooring and the second with neutral carpet.

Located next to the utility area is access to a west facing low maintenance patio garden.

This property is an ideal purchase for a first time buyer and could also be a great addition to an investment portfolio.

Other benefits include:

- New decoration
- New carpets
- Gas central heating
- Double glazing
- Close to shops and bus links

Viewings are highly recommended.

Video available on request.

Contact NEXA Properties to arrange a viewing.

SITUATION

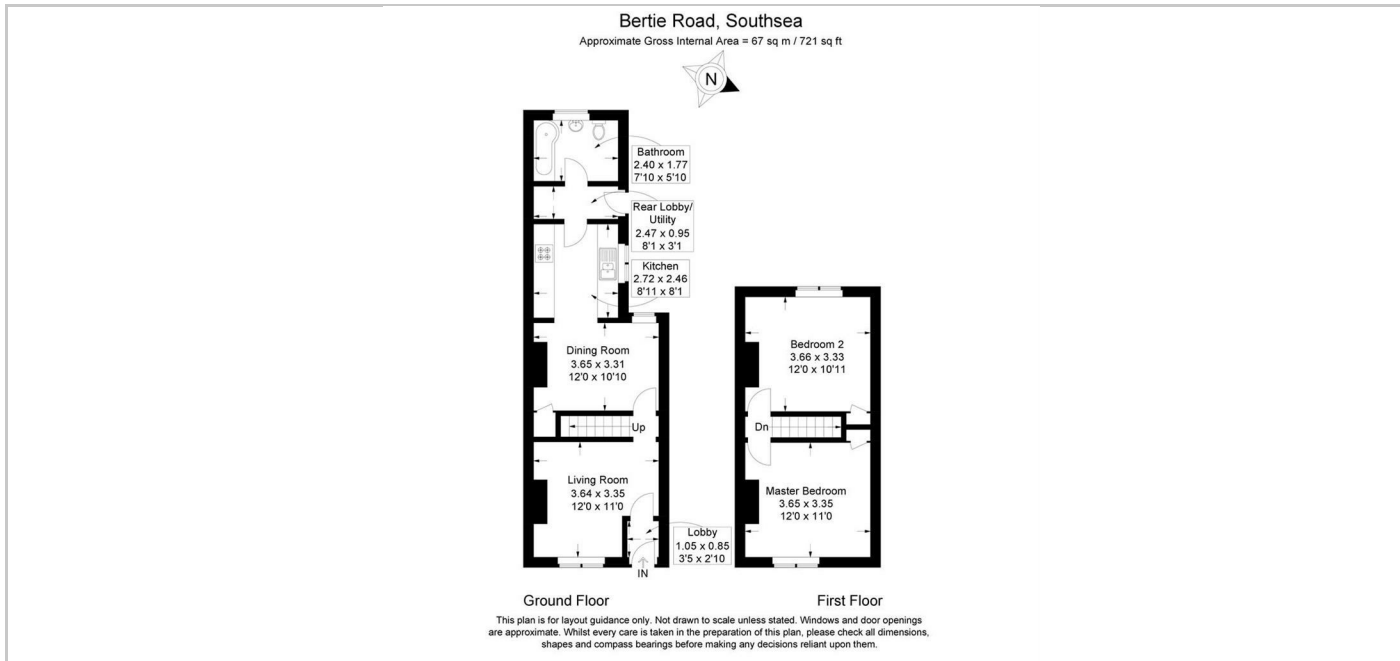

Directions

15 Hampshire Terrace, Southsea, Portsmouth, Hants, PO1 2QF
Tel: 02392295046 Email: hello@nexaproPERTIES.com <https://www.nexaproPERTIES.com/>