

NEXA
PROPERTIES



27 Herons Way, Gable Head, Hayling Island, PO11 9FL

£400,000

- FOUR BEDROOM DETACHED HOME
- COSY LOUNGE AT THE FRONT
- GARAGE CONVERTED TO UTILITY AREA AND STORAGE
- DOWNSTAIRS CLOAKROOM
- POPULAR PRIVATE ESTATE
- LARGE KITCHEN DINER
- OFF-ROAD PARKING FOR 2 CARS
- PRICED ATTRACTIVELY TO SELL
- EN-SUITE TO MASTER
- ON HAYLING ISLAND CLOSE TO BLUE-FLAG BEACHES

THE PROPERTY

PRICED TO SELL * FOUR BEDROOM DETACHED EX-NEW BUILD * POPULAR PRIVATE ESTATE IN GABLE HEAD, HAYLING ISLAND * LARGE KITCHEN DINER * EN-SUITE TO MASTER...

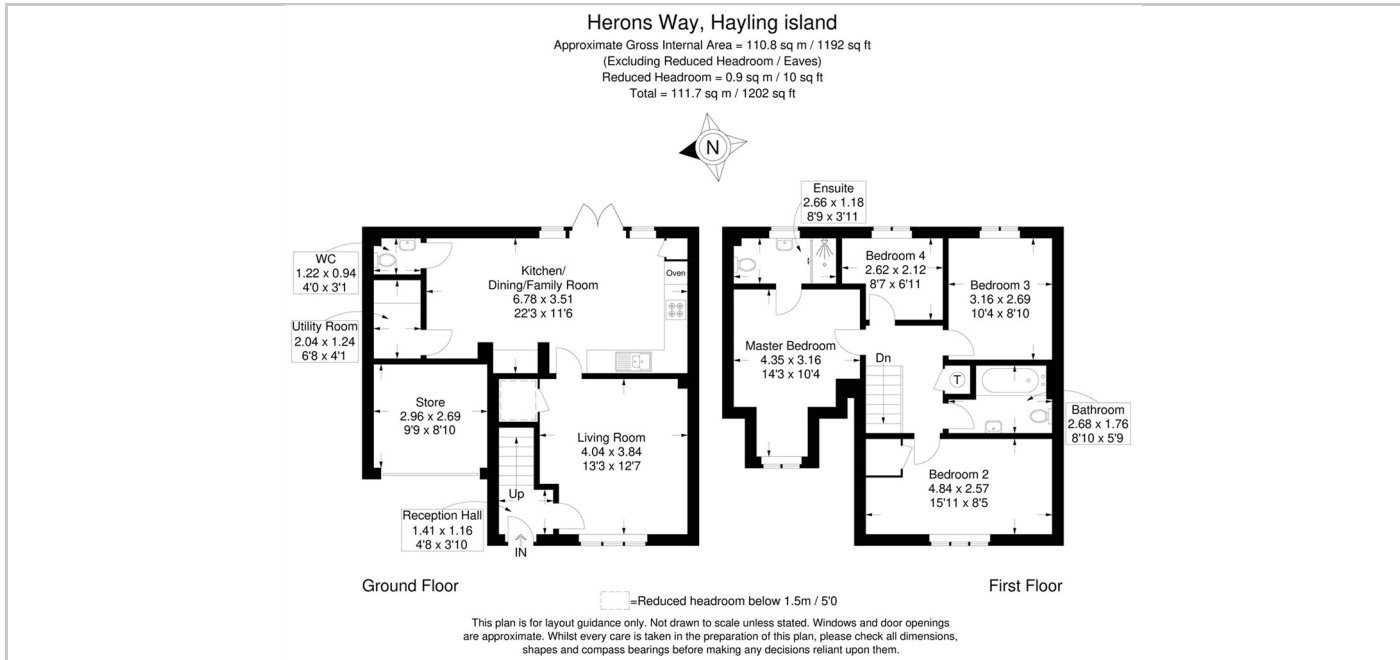

SITUATION

Directions