

**NEXA**  
PROPERTIES



**TO LET**



172 Chichester Road, Portsmouth, PO2 0AH

£320,000

- MID TERRACE HOUSE
- TWO RECEPTION ROOMS
- KITCHEN / BREAKFAST ROOM
- THREE DOUBLE BEDROOMS
- BATHROOM
- SPACIOUS
- NO FORWARD CHAIN
- ENCLOSED GARDEN
- CLOSE TO ALL AMENITIES

## THE PROPERTY

\*\* OFFERED WITH NO FORWARD CHAIN \*\* This 3 bedroom Victorian mid terrace property is conveniently situated within walking distance of all local amenities including transport links and Schools. Spacious accommodation for family living but also offers the scope and potential, subject to necessary consents.

Boasting appx 1500sqft, there are plenty of features throughout the property which make the character of this home, such as the fire surrounds, tall ceilings with centre roses, bay windows and large versatile rooms.

Accommodation comprises entrance hall, living room, dining room, large kitchen/breakfast room, bathroom and three double bedrooms.

The south facing garden offers a patio for entertaining and a useful shed with rear access to the communal pathway.

Viewing is highly recommended.

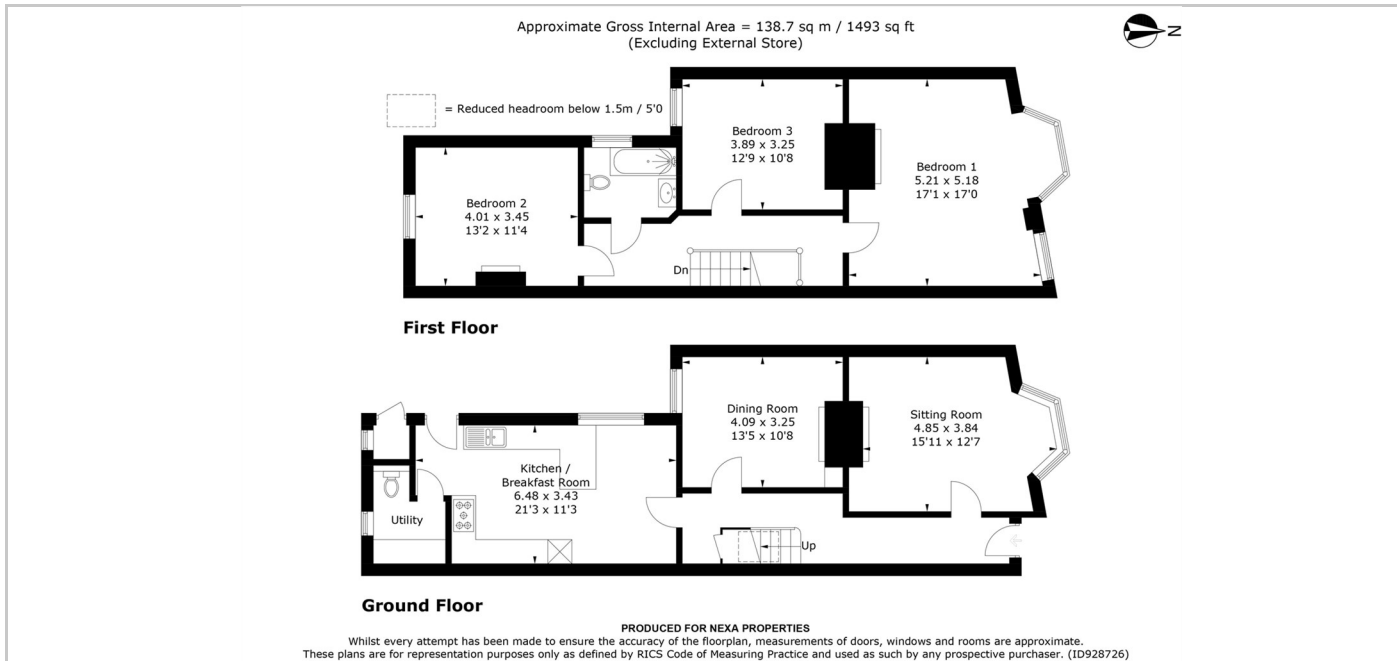

## SITUATION

## Directions