



31 Amethyst Grove

Waterlooville, Hampshire, PO7 8SG

Price Guide £310,000



4



1



2



31 Amethyst Grove



Description

Situated in the popular 'Tempest Avenue Estate' this four-bedroom mews home is available on the market for the first time in over 20 years. A fantastic residential location, ideal for families or first time buyers.

- FOUR BEDROOM MEWS STYLE HOUSE
- TWO ALLOCATED PARKING SPACES
- LOW MAINTENANCE REAR GARDEN
- LIVING ROOM
- TEMPEST AVENUE ESTATE
- OPEN PLAN KITCHEN BREAKFAST ROOM AND SUN-ROOM
- CLOAKROOM
- FURTHER SCOPE & POTENTIAL





Floor Plan

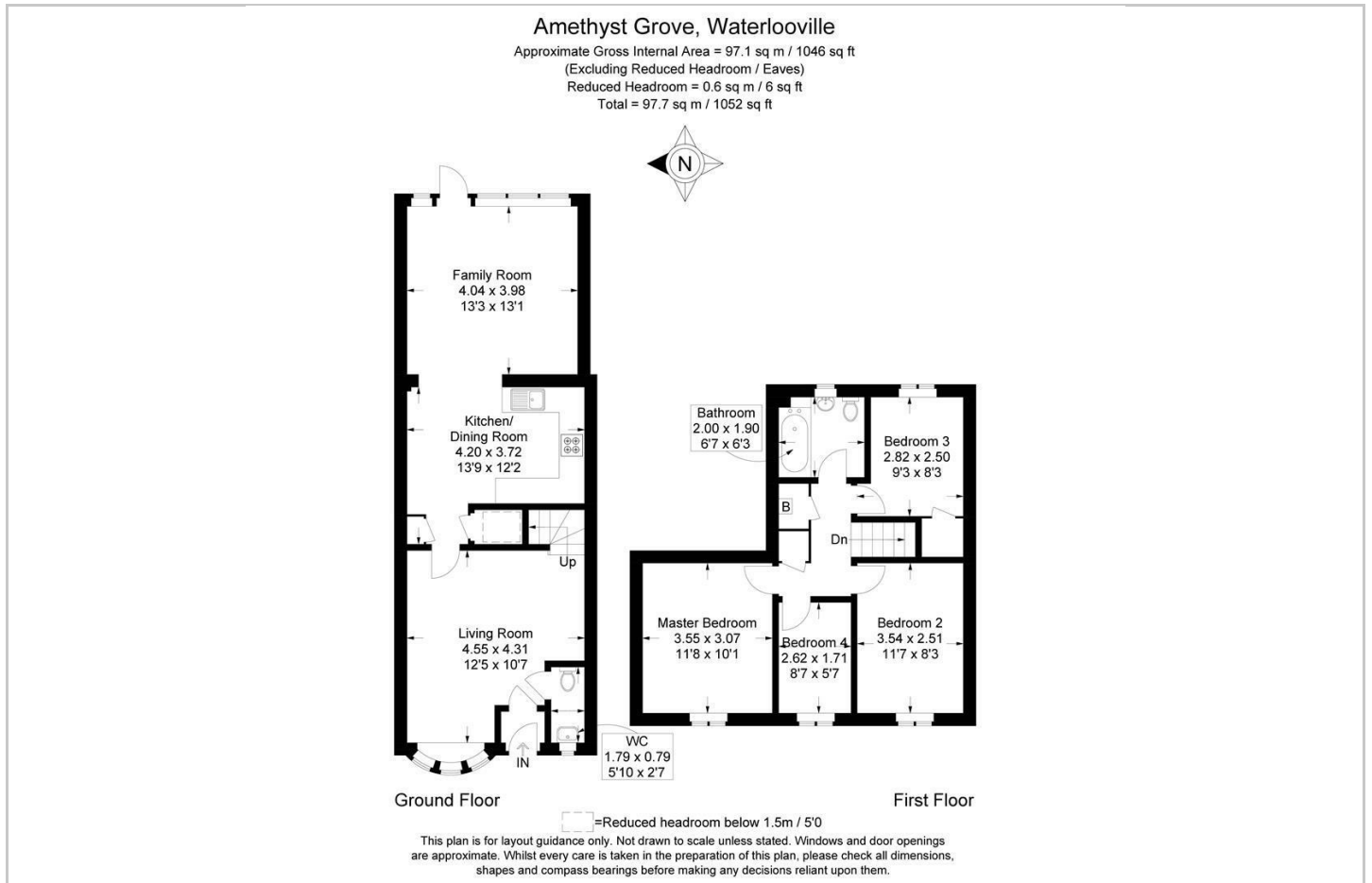

Area Map

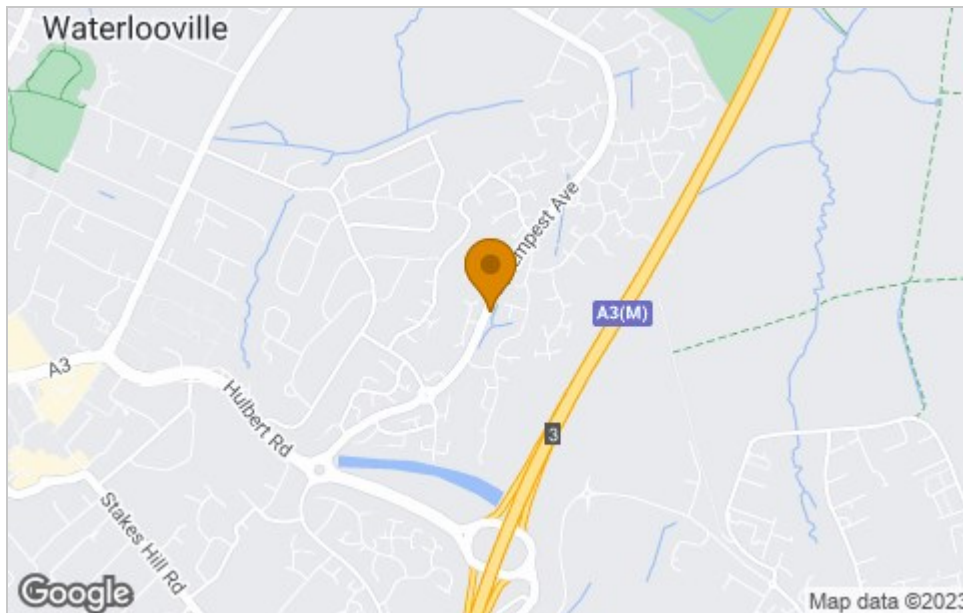

Energy Efficiency Graph

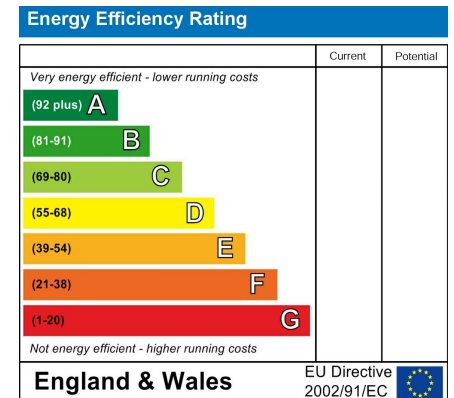

Viewing

Please contact our Nexa First Southern Region Office on 02392295046 if you wish to arrange a viewing appointment for this property or require further information.

These particulars, whilst believed to be accurate are set out as a general outline only for guidance and do not constitute any part of an offer or contract. Intending purchasers should not rely on them as statements of representation of fact, but must satisfy themselves by inspection or otherwise as to their accuracy. No person in this firm's employment has the authority to make or give any representation or warranty in respect of the property.