



68 Old Manor Way, Drayton, Portsmouth, PO6 2NN

£375,000

- £375,000 - £390,000 GUIDE PRICE
- DRIVEWAY FOR 2 CARS
- COURT LANE AND SPRINGFIELD SCHOOL CATCHMENTS
- DOWNSTAIRS WC
- GREAT SIZED GARDEN, LAID MOSTLY TO LAWN
- SEMI-DETACHED DRAYTON HOME
- GARAGE AT THE REAR
- LEAN-TO PROVIDING UTILITY AREA AND PLAYSPACE
- MODERN KITCHEN DINER
- CLOSE TO A27

THE PROPERTY

UNEXPECTEDLY RE-AVAILABLE ** GORGEOUS SEMI-DETACHED DRAYTON HOME ** COURT LANE AND SPRINGFIELD SCHOOL CATCHMENT ** GARAGE AT REAR ** DRIVEWAY FOR 2 CARS AT THE FRONT ** KITCHEN DINER IS HEART OF THE HOME ** MODERN BATHROOM ** COSY SEPARATE LOUNGE ** UTILITY AREA AND DOWNSTAIRS WC

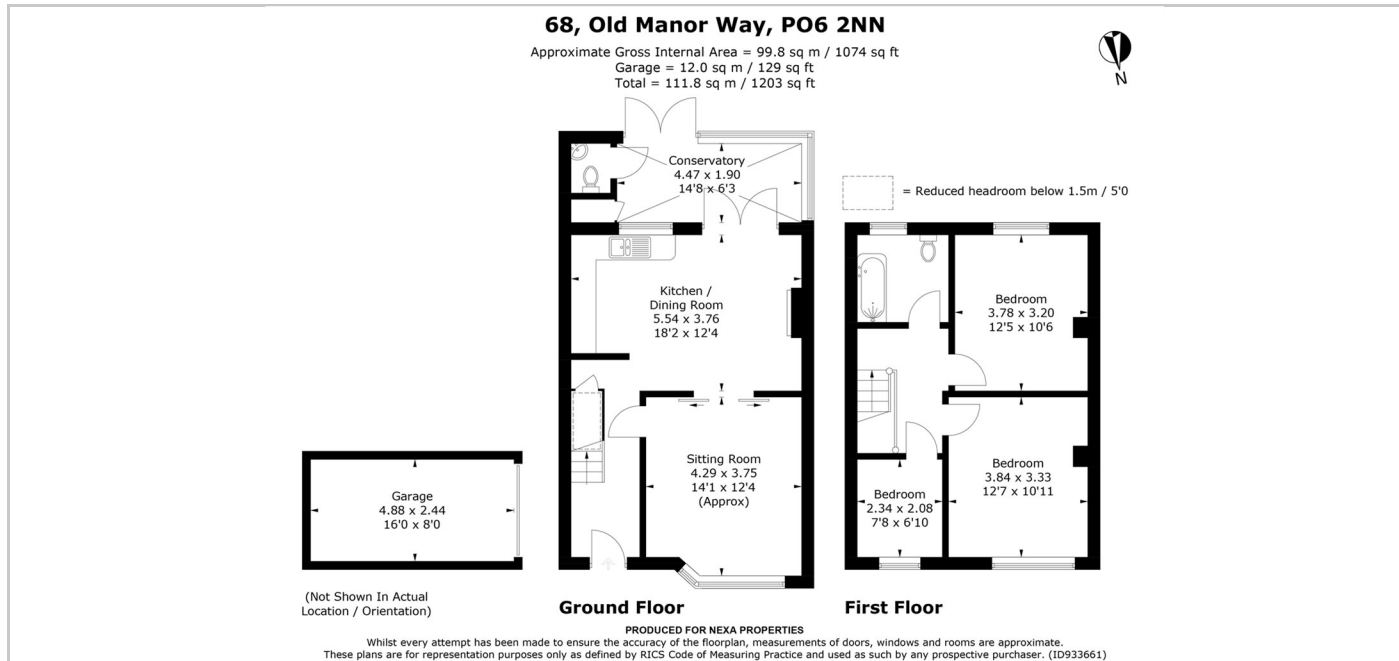

SITUATION

Directions