



10 Letcombe Place

Horndean, Waterlooville, PO8 0DE

Price Guide £290,000



Floor Plan

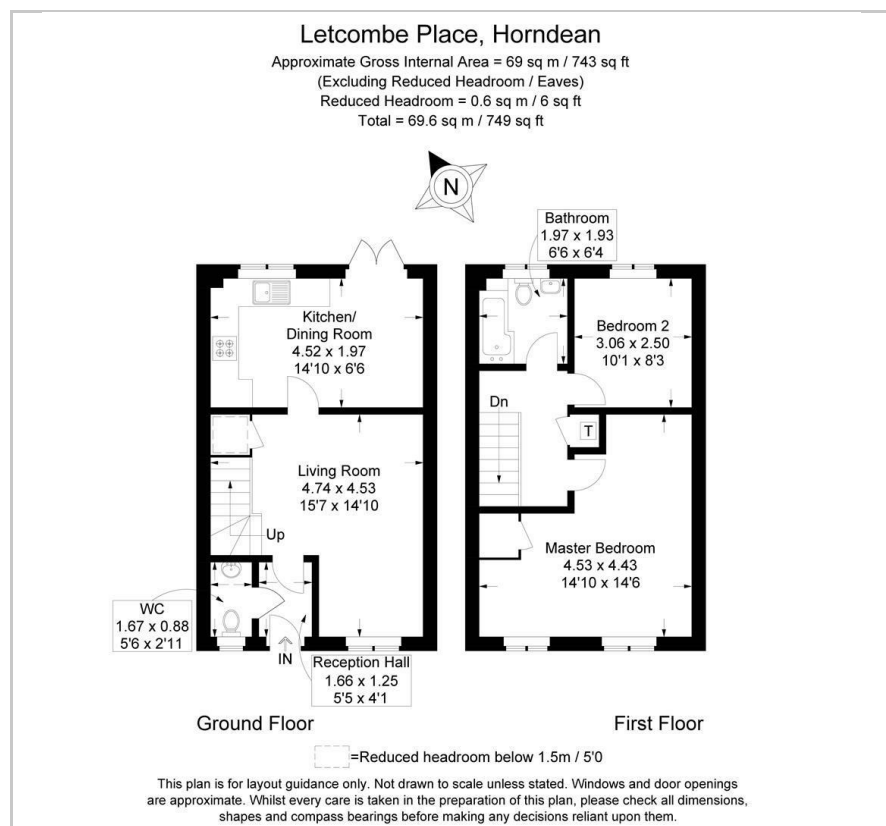

Area Map

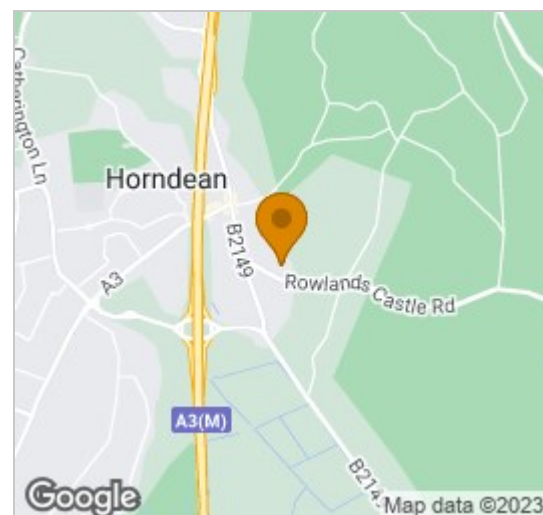

Energy Efficiency Graph

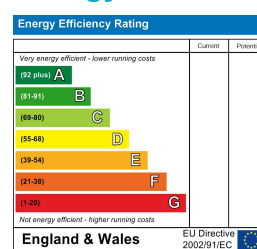

Viewing

Please contact our Nexa First Southern Region Office on 02392295046 if you wish to arrange a viewing appointment for this property or require further information.

- QUAIN MEWS HOME IN HORNDEN ■ £290,000 - £310,000 GUIDE PRICE VILLAGE
- ALLOCATED OFF-ROAD PARKING ■ MODERN, REFITTED BATHROOM AND FURTHER ON-STREET PARKING SUITE
- PRIVATE REAR GARDEN BACKING ■ PEDESTRIAN REAR ACCEESS TO GARDEN ON TO GREEN-BELT LAND
- DOWNSTAIRS CLOAKROOM ■ GOOD CONDITION
- IDEAL FIRST HOME

QUAIN MEWS HOME IN HORNDEN VILLAGE ** IDEAL FIRST HOME ** ALLOCATED OFF-ROAD PARKING AND FURTHER ON-STREET PARKING ** LARGE MASTER BEDROOM ** MODERN, REFITTED BATHROOM SUITE ** PRIVATE REAR GARDEN BACKING ON TO GREEN-BELT LAND



These particulars, whilst believed to be accurate are set out as a general outline only for guidance and do not constitute any part of an offer or contract. Intending purchasers should not rely on them as statements of representation of fact, but must satisfy themselves by inspection or otherwise as to their accuracy. No person in this firm's employment has the authority to make or give any representation or warranty in respect of the property.

15 Hampshire Terrace, Southsea, Portsmouth, Hants, PO1 2QF
 Tel: 02392295046 Email: hello@nexaproperties.com <https://www.nexaproperties.com/>