

NEXA
PROPERTIES



TO LET



Flat 2, Ophir Court, 8 Kent Road, Southsea, PO5 3EN
£100,000

- LARGE STUDIO / ONE BEDROOM
- MEZZANINE LIVING AREA
- LET AT £675PCM FOR 12 MONTHS FROM NOVEMBER 2022
- CENTRAL SOUTHSEA LOCATION
- LEASE EXTENDED
- NO FORWARD CHAIN
- FITTED BATHROOM
- OPPORTUNITY FOR INVESTOR TO TAKE OVER THE TENANCY
- 29 METRES SQ / 313 SQ FT.

THE PROPERTY

INVESTORS ONLY, LET FOR 12 MONTHS AT £675PCM * STUDIO FLAT * QUIRKY MEZZANINE LEVEL * LEASE EXTENSION JUST COMPLETED *

We are proud to market this third-floor split level studio flat on Kent Road, just steps away from Southsea Common and the beach.

The lease has been extended to 150 years and the combined costs for service charges and insurance is £850 per year which is very reasonable against similar buildings nearby.

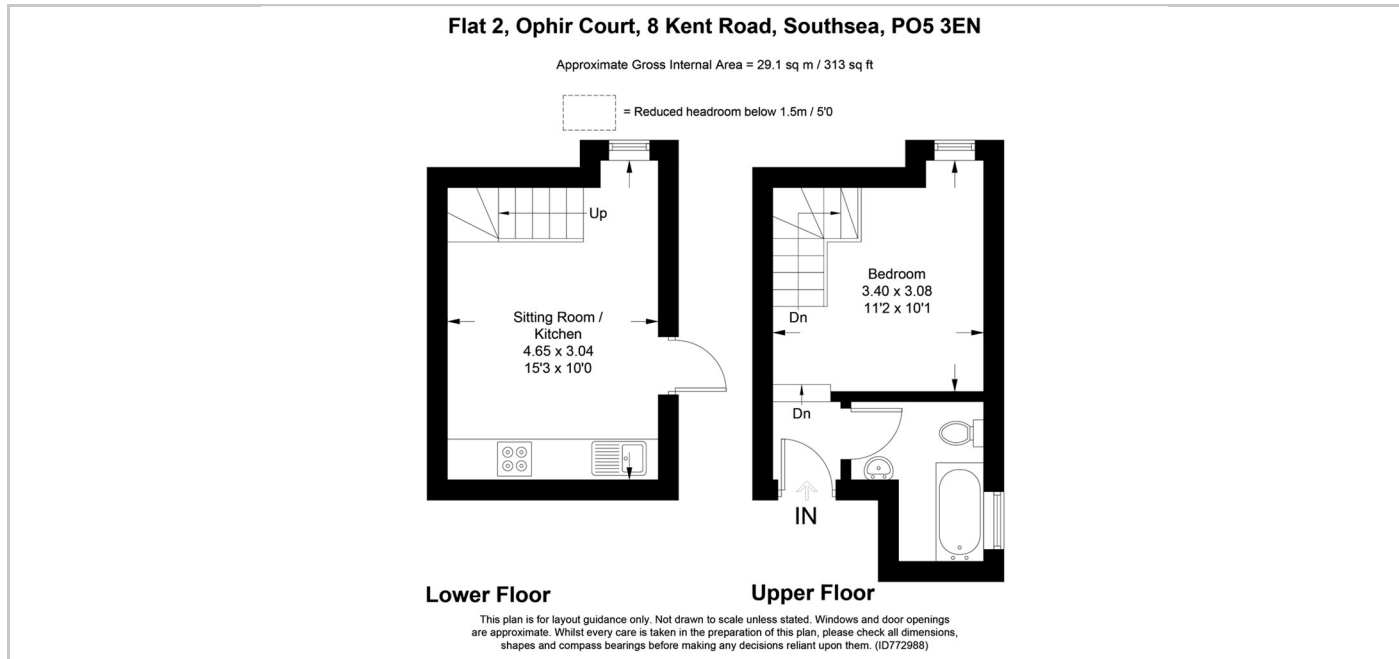

SITUATION

Directions